

PUSH TROLLEY 10.0T (125-305MM)

Brand: **Austlift**

Product Code: **131030**

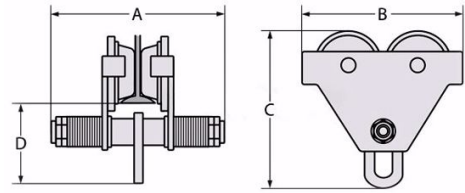

PUSH TROLLEY 10.0T (125-305MM)

This 10T Austlift Plain Trolley is moved by pushing the load lifted by the trolley, running along a flange of a monorail. A main shaft with spacers you can adjust the width of UB/UC beam. They are widely used in Factories, Mines, Wharves, Docks, Warehouses and Engineering Workshops for installation of equipment in places where no power supply is available.

Features:

- * High quality sealed ball bearings.
- * Identification tag with serial number.
- * Proof tested to 2 x WLL with certificate.
- * Fitted with anti-drop plates for safety.
- * Low headroom by design.
- * Complies to AS1418.2.

Hook Eye Dimensions:

Widest: 65 mm

Narrowest: 57 mm

Length: 95 mm

Specifications

Beam Flange Width	125 - 305 mm
Body Material	Steel
Dimension A	468 mm
Dimension B	389 mm
Dimension C	460 mm
Dimension D	237 mm
Mn. Radius of Curve	2.0 m
Weight	83.3 kg
WLL	10,000 kg (10T)