

## 3/4"DR STEEL SKT POR 996/997 CUP

Brand: **Paoli Pit Stop**

Product Code: **B.28.0016**

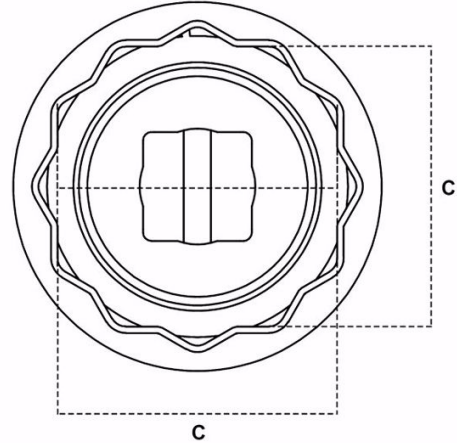

### 3/4"DR STEEL SKT POR 996/997 CUP

3/4" Square Drive Paoli Lightweight Polygonal motorsport socket w/o retaining system to suit SW 36 mm Nut size for Porsche 996 & 997 Carrera Cup vehicles - designed for garage use only.

This socket is manufactured from high resistance steel, making them VERY light (just 780 grams).

#### Attachments

[Paoli Pit Stop Motorsport Sockets\\_2019](#)

#### Specifications

Application Example	Porsche 996 & 997 Cup
Dimension C	32 mm
Material of Construction	High Resistance Steel
Nut Size	SW 36 mm
Square Drive	3/4"